

NOTICE OF CONSTRUCTION

Southern California Edison West of Devers (WOD) Upgrade Project Activity

Southern California Edison (SCE) is building the West of Devers Upgrade Project to provide the additional capacity necessary to bring renewable and conventional generation being developed in desert areas around Blythe and Desert Center, California. These significant upgrades will enhance electric reliability for all customers and help to make the power grid greener for California.

Extended Construction Hours: between August 1st and December 31st, 2019 – To facilitate completion of work scheduled during a non-customer impacting outage coordinated with the California Independent System Operator (CAISO), in general, work will occur between 6 am and 7 pm, but may start as early as 5 am and continue until 8:30 pm, as project conditions require. Work will generally occur Monday through Saturdays and occasionally on Sundays as project conditions and weather impacts require.

Location of Extended Construction Hours: between August 1st and December 31st, 2019 Crews will be working in the Project Right-of-Way in areas of unincorporated Riverside County between Devers Substation in North Palm Springs and Rushmore Avenue in Whitewater.

Scheduled Activities:

- Site preparation
- Removal and replacement of overhead lines
- Modification, installation and removal of poles and towers
- Duct bank and vault installation
- Foundation installation
- Counterpoise installation
- Shoo Fly installation and removal
- Helicopter operations
- Wire Stringing
- Transmission wire and optical ground wire pulling and splicing
- Restoration activities

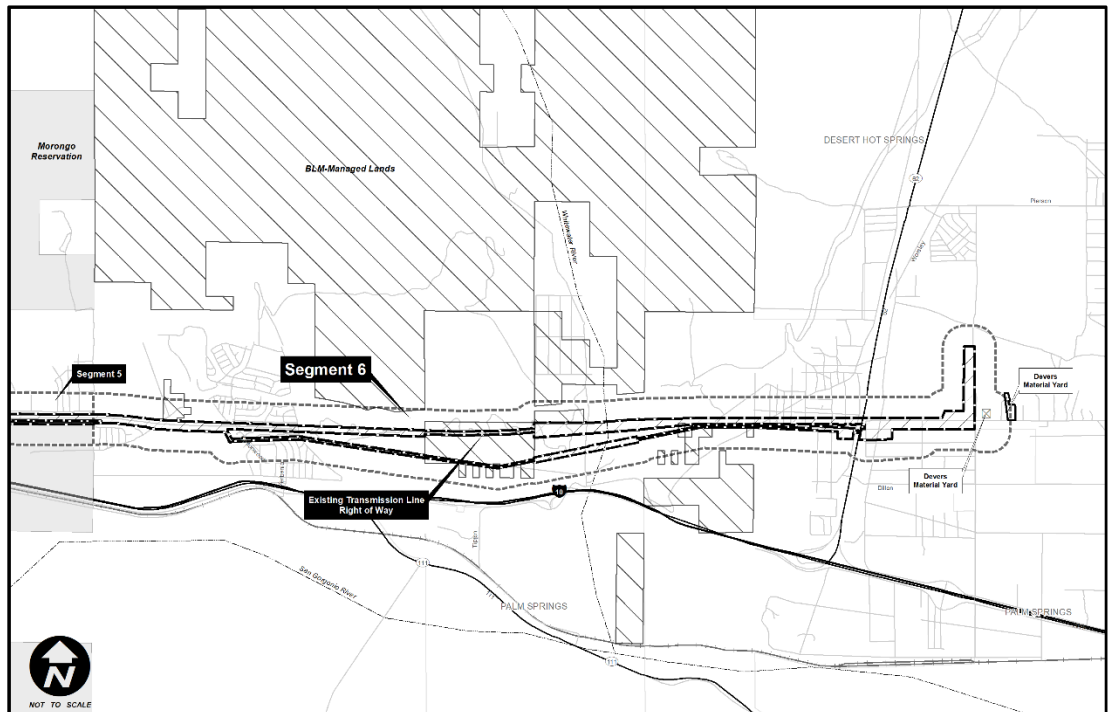

Every effort will be made to reduce the amount of noise generated by activities related to construction. SCE understands that construction may be inconvenient to residents, businesses, and visitors. We greatly appreciate your patience as we move to complete construction as quickly and safely as possible.

Power Outages: The West of Devers Project does not have any customer impacting power outages planned for this effort at this time.

Questions? / ¿Preguntas?

Call our toll-free line 888-226-9916, where your call will be routed to effectively resolve your concern.

Project Liaison: Debrah Bishop

Para información en español, llame al 888-226-9916

Visit our Project website www.on.sce.com/devers